



# Preventative Maintenance

ECLIPSE® and ECLIPSE 2™  
Oxygen Systems  
Models 1000 & 1000A  
102008



11436 Sorrento Valley Road • San Diego, CA 92121 • [www.sequal.com](http://www.sequal.com) • 858.202.3100



## Expectation:

---

Complete PM schedule for Eclipse devices

Detailed technical information and data for Eclipse devices can be obtained by consulting the Provider Technical Manuals available in hard copy or at our website **[www.sequal.com](http://www.sequal.com)**



## Inside the Eclipse

- 1 Compressor Intake Filter
- 1 HEPA Filter
- 1 9 VDC battery

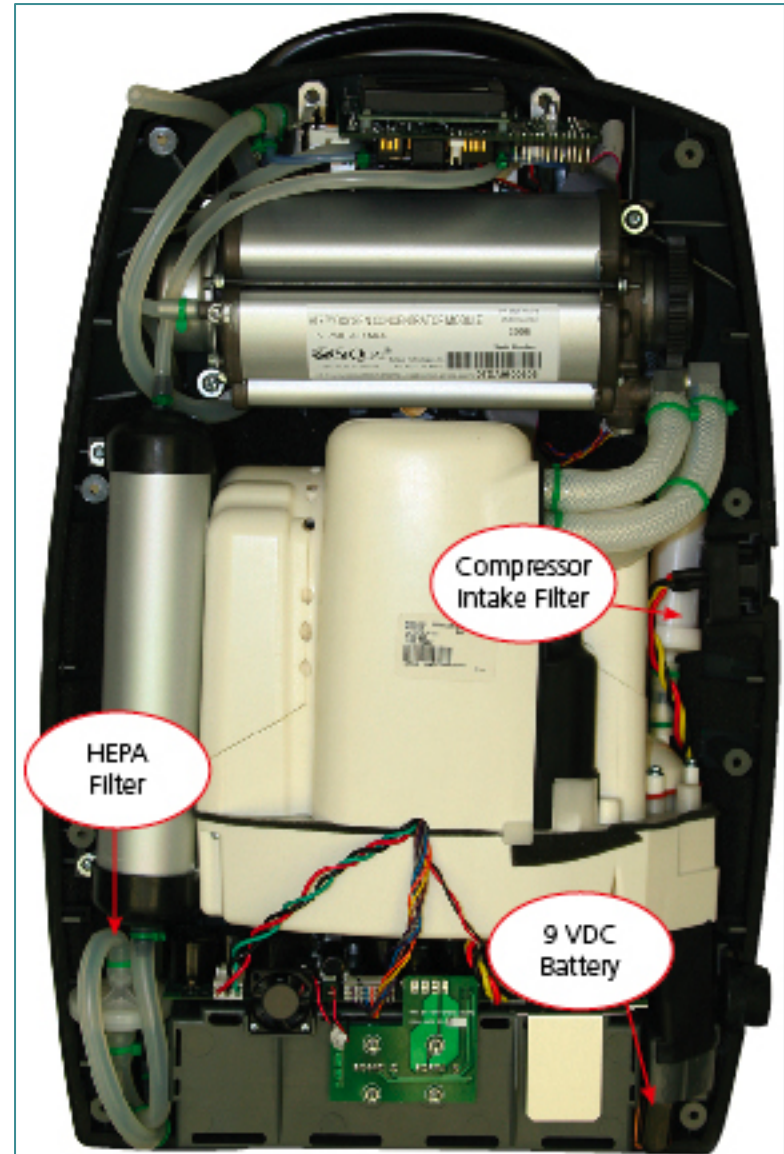



## Outside Eclipse

### 1 Air Inlet Filter

*(spare provided to user  
for periodic maintenance)*

*(Provided in PM Kit P/N: 5022)*





# The PM & Time Intervals





## When, and how often, to do PM Maintenance?

---

- **Factors to consider:**
  - Hours of operation
  - Environmental:
    - Dust/dirt/soot
    - Pets (cats especially)
    - Smokers in the same location
    - Proper external filter maintenance
    - Heating method at the location (oil, gas, wood)

**If it's open – Do the PM.**





## Eclipse® & Eclipse 2™ Preventive Maintenance Kit

**Part #: 5022**

- Compressor Intake Filter
- HEPA Filter
- Cabinet Filters (2ea)
- 9v Battery
- Foam Adhesive Tape
- Zip Ties (10ea)





# How to do it



11436 Sorrento Valley Road • San Diego, CA 92121 • [www.sequal.com](http://www.sequal.com) • 858.202.3100



**DO NOT** attempt to open an Eclipse device without using adequate ESD protection or damage may result



## Removing the cover

First...

- Disconnect Eclipse from external power and remove power cartridge.



Place device on an approved ESD mat or bench.

Next...

**eclipse2™**  
with autoSAT™



- Turn unit on it's face
- Remove ten #1 Phillips screws from cover & carefully turn unit onto it's back.
- Remove face cover assembly being careful not to damage the control panel cable and oxygen delivery tubing.



Support as necessary.



Then ...



# The PM

- Remove and replace 9VDC battery located at the bottom of Eclipse.
- Use the foam adhesive tape to secure the 9v battery to prevent rattling inside the Eclipse

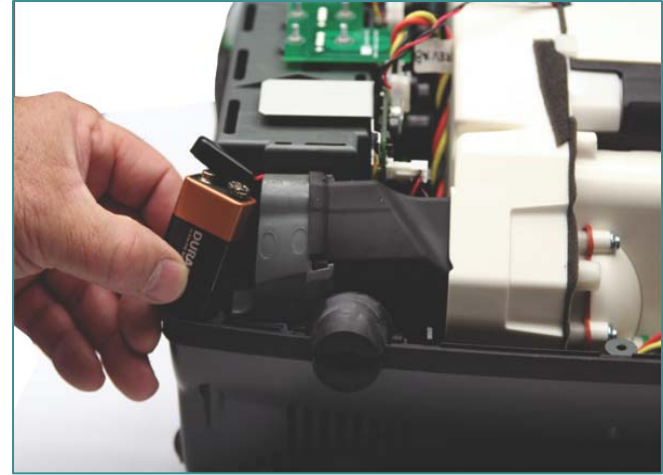

9v battery and adhesive foam tape provided in PM Kit (P/N:5022)

# The PM

- Remove and replace the HEPA filter located at the bottom of the product tanks. (*Observe the flow direction on filter face.* Inlet side of the filter is coming from the lower product tank and the Outlet to upper product tank.)
- Secure with tie wraps. (Provided in PM Kit P/N: 5022)
- Place the HEPA filter back in the appropriate slot to ensure proper flows

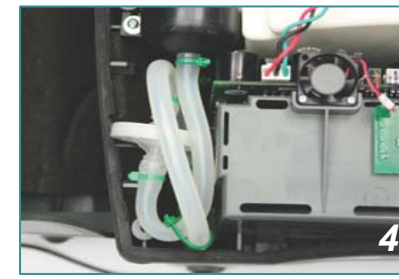
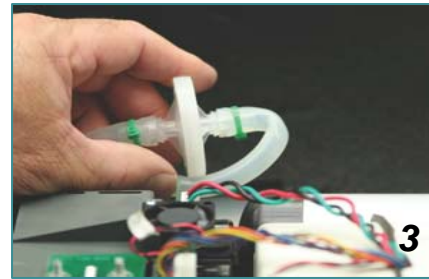
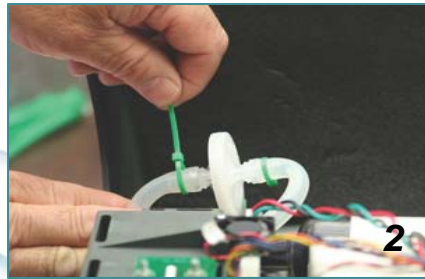
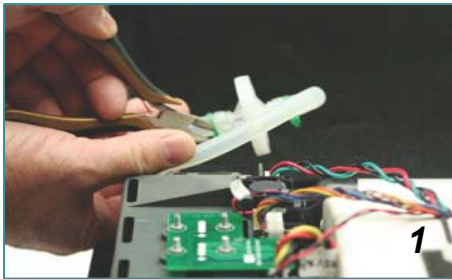
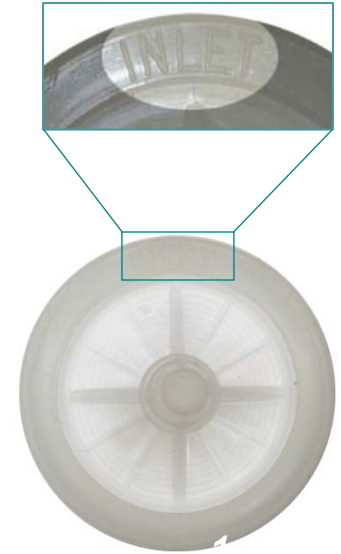

- Remove and replace Compressor Intake Filter located next to the Compressor Module.

Observe flow direction on the body of filter.

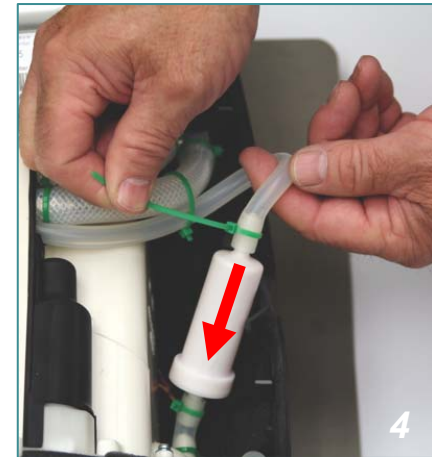
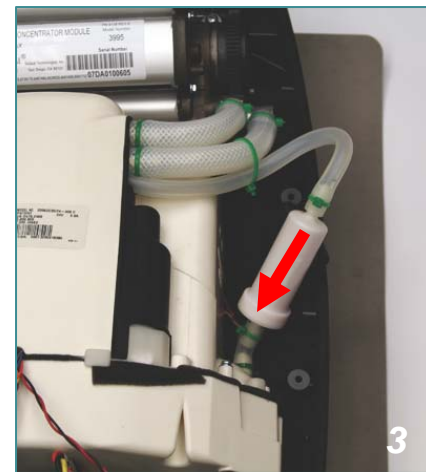
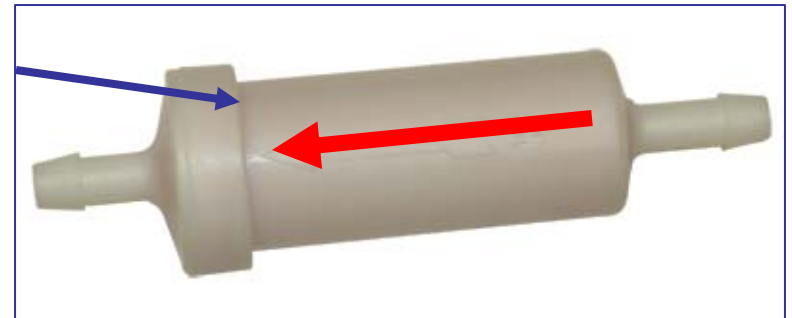

## Electrical Connector orientation

E 1

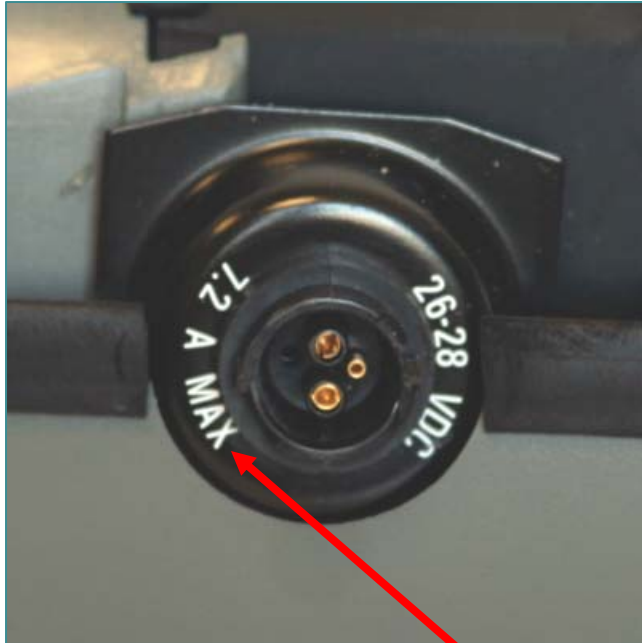

E 2

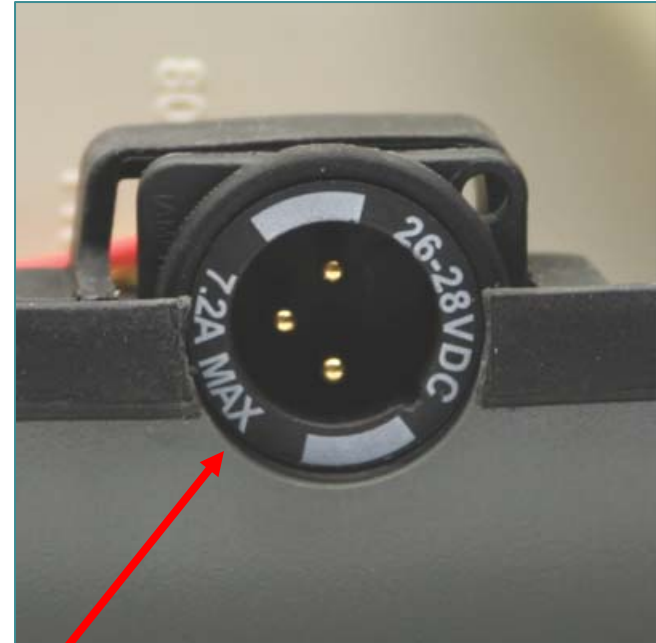

**Note:** The “7.2 A Max” is always towards the bottom of the unit

**Eclipse 2**: Ensure the O-ring is correctly installed on Power Harness before inserting it into the case.





**Eclipse 1**: Ensure Power Harness is properly installed before closing the unit.

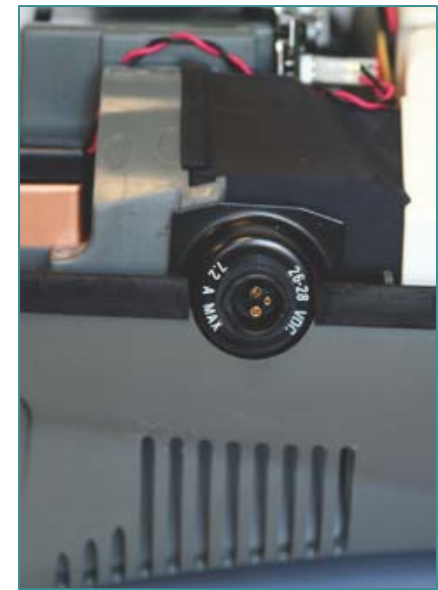

## Recommendation:

It is advisable to operate the Eclipse while it is still open to observe that there are:

- No leaks at the filters
- No kinked oxygen lines
- All alarm indicators are off after ten minutes of running



- Replace front panel cover and carefully turn unit onto it's face.

*(ensure gasket is in line)*

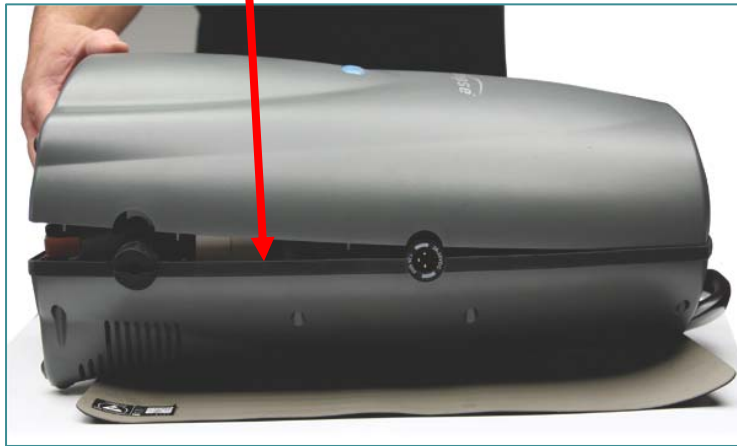

- Install ten #1 Philips screws



Case Screws - Part # 6974-312 (50 ea)

- Remove and replace Air Inlet Filter Provide spare to patient.  
(Provided in PM Kit P/N: 5022)





- Clean exterior of device with damp cloth.
- Do not expose Eclipse to excess water.

Damage could result.



- Operate Eclipse for at least 20 minutes.
- Test and certify the device for “RETURN TO SERVICE” based on your normal operating practices.





# Document PM.

## SERVICE AND MAINTENANCE RECORD

Eclipse Serial Number _____							
Date	Hour meter Reading	Initials	Service Performed	System Checkout			Comments
				Purity	Flow	Alarms	



## Some sample views of new and clogged filters

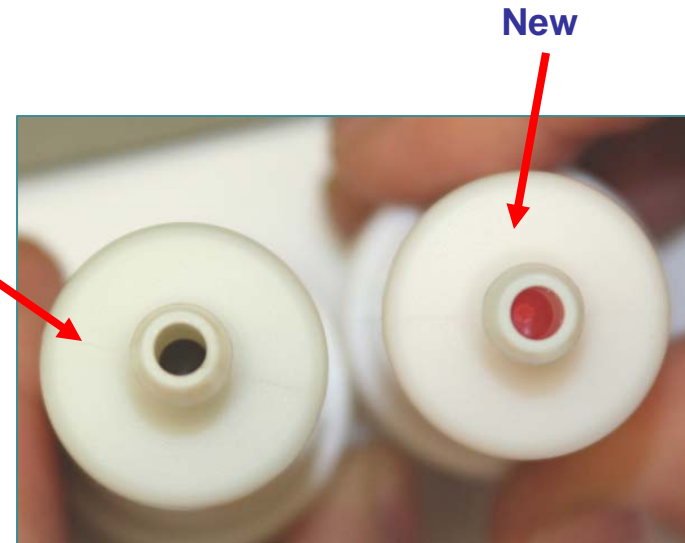





**For Technical Assistance**

**Contact:**

**SeQual Technologies, Inc.**

**Toll Free: 800.826.4610 select #5**

**Local: 858.202.3277 select #5**

**or for provider manuals go to**

**[www.sequal.com](http://www.sequal.com)**

**Provider Portal**

**User Name: integra**

**Password: advantage**

